

See other map linked to the web page for a more detailed close-up of the area around our house

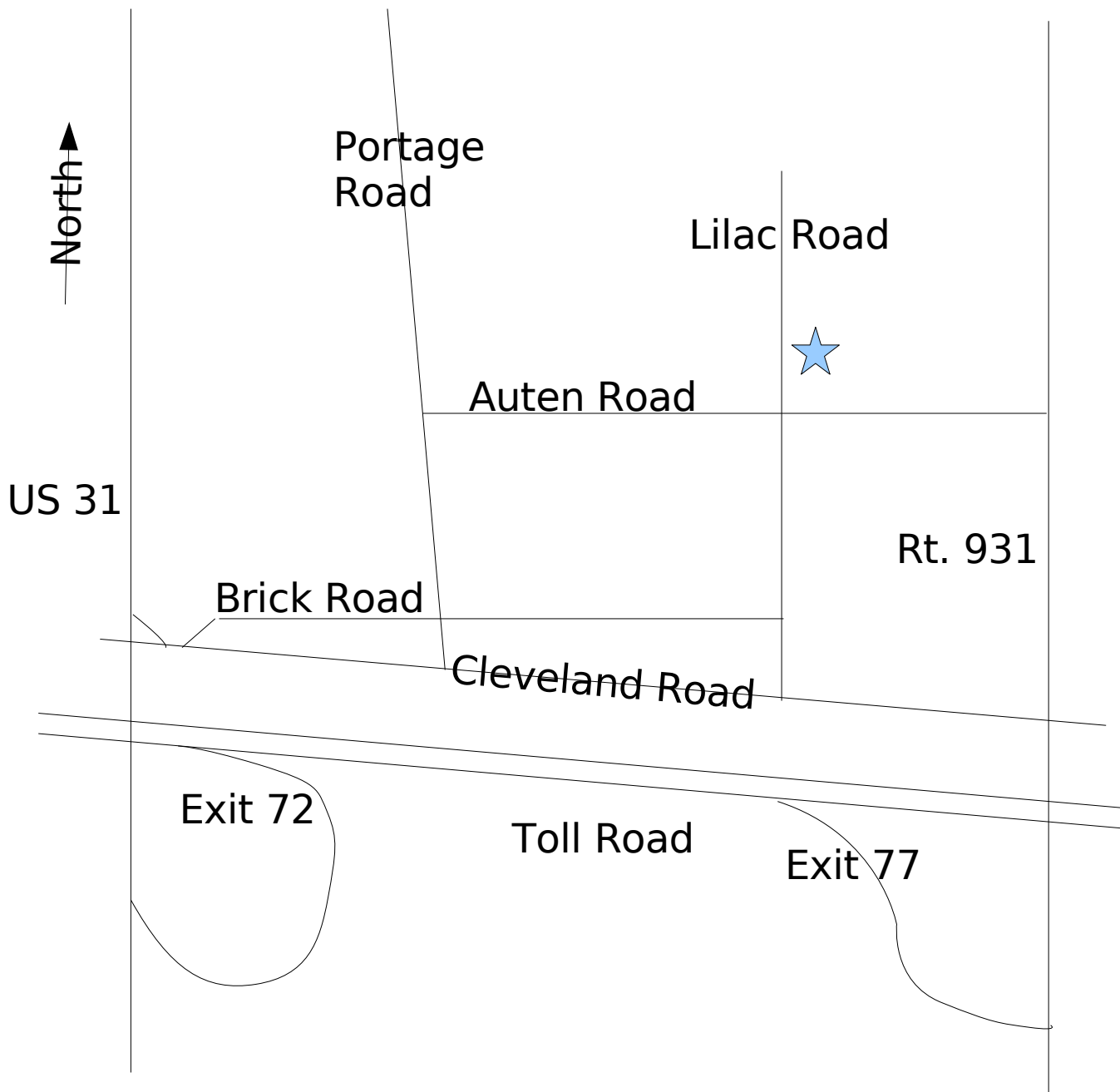

From the West: exit Toll Road at exit 72, head north on US 31 towards Niles, Michigan. Take the first exit on Cleveland Road, turning left (East) on Cleveland towards South Bend. After passing through one stop light, turn left onto Brick Road. Stay on Brick until it tees into Lilac, then turn left. We are the second driveway on the right after you cross Auten Road, which is the next road crossing.

From the East: Exit the Toll Road at exit 77, turn left (north) on 931. Follow 931 north until you get to Auten Road, then turn left. Lilac Road is the road you cross immediately after you cross the river.